

Product Portfolio

Sheets, compression molded OKULEN® 300 (HDPE) OKULEN® 500 (HMW-PE) OKULEN® 1000, OKULEN® 2000 (UHMW-PE) OKULEN® PP natural, OKULEN® PP grey further dimensions on request Welding possibilities of UHMW-PE on request.	H 4 – 400 mm ⁽¹⁾	L x B 2000 x 1000 mm 2000 x 1200 mm 2500 x 1200 mm 3000 x 2000 mm 3050 x 1220 mm 4000 x 2000 mm 6000 x 2000 mm 6000 x 2500 mm 8000 x 1000 mm
Sheets, skived OKULEN® 1000 further thicknesses and dimensions on request	1 – 5 mm	2000 x 1000 mm
Sheets, extruded OKULEN® HDPE further thicknesses and dimensions on request	1 – 5 mm	2000 X 1000 mm

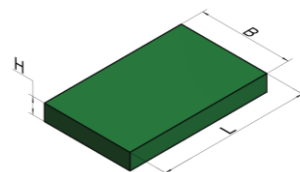

Rod, L = 1000 or 2000 mm	
OKULEN® 2000, RAM-extruded OKULEN® 500, OKULEN® 1000, OKULEN® 2000, made from sheets.	Ø 20 – 200 mm Ø 10 – 380 mm ⁽¹⁾

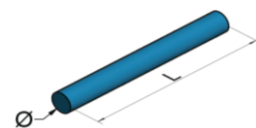

Discs, Ø 200 – Ø 1280 mm⁽³⁾	
OKULEN® 1000 (UHMW-PE), OKULEN® 2000 (UHMW-PE) PP natural, PP grey, PVDF, PTFE, PFA Welding possibilities available up to a thickness of 1000 mm. Discs may also be pressed with precasted shapes in order to save material. We would appreciate to get the drawing of the finished part in order to consider a precasted shape.	H = 20 – 380 mm ⁽²⁾ H = 20 – 380 mm ⁽²⁾

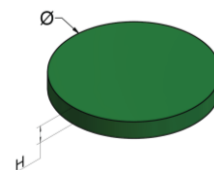

Rings, Ø 200 – Ø 1280 mm⁽³⁾	
OKULEN® 1000 (UHMW-PE), OKULEN® 2000 (UHMW-PE) PP natural, PP grey, PVDF, PTFE, PFA Welding possibilities available up to a thickness of 1000 mm. Discs may also be pressed with precasted shapes in order to save material. We would appreciate to get the drawing of the finished part in order to consider a precasted shape.	H = 20 – 380 mm ⁽²⁾ H = 20 – 380 mm ⁽²⁾

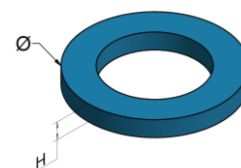

(1) = in dependence of the material and the machine.
 (2) = in dependence of the ratio between diameter and thickness.
 (3) = we request your finished dimensions in order to produce economic for you.

Ottensteiner Kunststoff GmbH & Co. KG Im Garbrock 39, 48683 Ahaus-Ottenstein, Germany	Tel. / Phone: +49 (0) 2561-9824-0 Internet: www.okulen.com E-Mail: Info@okulen.com
--	--